

**LOZZA** Collection  
TOTO by alvinT

Simplicity is a timeless and essential principle that holds profound significance in our lives. It is not merely a design aesthetic or a minimalist lifestyle choice; rather, it encompasses a philosophy that can lead to greater well-being, clarity, and fulfillment.

## Table of Contents

2	About TOTO
4	About LOZZA
5	About the Designer: Alvin Tjitrowirjo
9	Room for Reflection with Nikita Stephanie
13	Faucet Fittings
21	Bath Fittings
29	Shower Fittings
38	Index Page
41	Technical Drawings

## About TOTO

Founded in 1917 by Kazuchika Okura, TOTO is the world's largest toilet manufacturer. Driven by Japan's spirit of perfection, the company has not only pioneered the development of modern sanitary ware, it has also changed the way we experience the bathroom. Over the years, its unparalleled commitment to quality and innovation has earned the company its reputation as a trendsetting and trustworthy go-to brand for private homes and commercial establishments alike.



## About LOZZA

In today's modern lifestyle saturated with information & distraction, the LOZZA Collection offers to promote clarity & tranquility. Composed of its most essential elements with controlled curves, softened edges, the result is a simple yet resolved silhouette to create a timeless design that effortlessly elevates any environment. With LOZZA, we wish to create an environment where your daily rituals become a source of tranquility, where your habits find a home in a design that nurtures simplicity and functionality.

With thoughtful selection of detail & function the collection of bathroom fittings ensures that each element serves a purpose, eliminating unnecessary distractions. This mindful approach encourages users to engage in purposeful activities, fostering a more conscious and intentional bathroom routine.

It invites individuals to disconnect, recharge, and rediscover moments of clarity and mindfulness within their homes, fostering a harmonious balance between the demands of the external world and the need for personal well-being.

## About the Designer : Alvin Tjitrowirjo

Founder and creative director of furniture brand and studio alvinT, Alvin Tjitrowirjo is best known for his material-forward and localised design language that fuses artisanal craftsmanship with modern sensibilities. Fueled by critical thinking and psychological reflections, his creations address the role of design beyond aesthetics, exploring the ways it interacts and responds to the surrounding space and community it was designed for. Working across furniture and interior design, some of his most notable pieces include the award-winning Linger Bench and Tropicaliá Modernity collection that showcases colourful furniture in traditional rattan weavings.

For the LOZZA Collection exclusively designed for TOTO, Alvin draws inspiration from the heightened awareness that surfaced during the pandemic: to focus on what is essential and what really matters. Revisiting the fundamentals, the sentiment is translated into a series of faucets stripped of any unnecessary adornment, with softened edges and a clean silhouette resembling a lozange or tablet, hence the name.

With an emphasis on function and efficiency, the LOZZA Collection also offers a meditative and intuitive user experience, while also stretching the definition of good design beyond being something that catches attention or is tagged as 'luxury', highlighting a sense of simplicity that doesn't adhere to fluctuating trends, but a style that will stand the test of time.

In Alvin's words, he hopes the LOZZA Collection can prompt users "to better understand and see deeper into a product beyond their aesthetics, tying back to that question of essentiality."







## Room for Reflection with **Nikita Stephanie**

In line with the anchoring values of LOZZA Collection, Room for Reflection meditates on the language of simplicity through design and the need to go back to the essentials in an era of excess and rapidly changing trends.

We talked to the founder of NN Studio, Nikita Stephanie about the role it plays in her creative practice.

Nikita Stephanie approaches design through a conscientious, experiential lens. For the founding principal and design director of Singapore-and-Bandung-based NN Studio, it's the first thing that she imagines when working on a project, concentrating her focus on a clear sense of what it feels like to interact with and be in a space.

Embodying these sensibilities, Nikita believes that design doesn't necessarily have to be the main character of the show. On the contrary, she adopts a subtle design language where various elements come together to complement the whole experience, like pieces of a puzzle unified in telling one story.

Villa Soka in Bali, a tropical villa project Nikita and NN Studio completed in 2023. Adopting an open-air layout, the villa is designed to focus on the surrounding natural elements.





One of the distinct features of Villa Soka is that every bathroom and bedroom is positioned to face the ocean view.



Nikita's work for River Valley Home in 2022 adopts a pared-down, minimalist design for the dining area.

Primarily working across residential homes, her works celebrate craftsmanship and a close eye for detail that emphasises the surrounding landscape and context, directing the attention to one focal point. For instance, in a recent project for a tropical villa in Bali, Villa Soka, the studio ensures that the interior is done in a way that points the focus to the beach view and nature.

Meanwhile, the L-shaped outdoor pool intentionally stretches out, appearing to merge with the ocean—conjuring a sense of serenity and calm. **“What will leave a lasting impression is the feeling people remember when being in a space. It’s the role of the design, through details and materials, to build this experience,”** Nikita explained.

The goal is to create a sanctuary that leaves room for silence and reflection. **“Simple aesthetics allow us to experience a space more clearly. There’s no clutter or distraction, and that enables us to be more present both with ourselves and the space itself.”** Amidst clean lines and neutral, earthy tones, Nikita and the team of NN Studio find a lot of room and flexibility to experiment. To them, minimalism isn’t something that restricts their exploration, but rather a welcome challenge to continue to find new ways to communicate only what is essential using different materials, colours and finishing techniques.



# Clarity

In a world filled with complexity and distractions, simplicity acts as a beacon of clarity.





## On Clarity

In a world often muddled by complexity and endless distractions, simplicity becomes a soothing beacon of clarity. LOZZA gracefully simplifies the complex, allowing you to focus on what truly matters. In these moments, our energies find renewed purpose, and our surroundings take on a deeper significance. With the LOZZA Collection, discover a subtle invitation to find tranquility in the gentle embrace of simplicity.



TX 115 MMC | Single Lever Lavatory Faucet with 1 1/4" Pop-Up Waste





TX 119 MMC | 8" Lavatory Faucet with 1 1/4" Pop-Up Waste

# Timelessness

Timeless design values the integrity of the design itself rather than relying on superficial ornamentation or fleeting trends.



## On Timelessness

Celebrating enduring design principles, the LOZZA Collection stands as a steadfast symbol of timeless beauty. It cherishes design integrity over passing trends, prioritizing reduced aesthetics through its clean lines, balance, and harmonious proportion.

This dedication results in a lasting aesthetic that gracefully matures with time. LOZZA uncovers the profound beauty found in simplicity and intuition, demonstrating how life can be made more effortless. Discover the art of timeless beauty with LOZZA, where trends may come and go, but its essence remains eternally captivating.









TX 494 MMC | Floor Standing Bath & Shower Set



# Rituals and Routines

The secret to your future is  
hidden in your daily routine.





## On Rituals & Routines

In our lives, rituals and routines hold a special place, providing structure, order, and moments of self-care and reflection. The bathroom, a versatile space, supports these daily practices that enhance our physical and mental well-being.

The LOZZA Collection gently aligns with the essence of essentials and simplicity, creating space for what truly matters. Within LOZZA's calming embrace, our rituals and routines discover a subtle source of inspiration.

A spatial sanctuary that breathes life into the essentials that resonates with the enduring beauty of simplicity. Welcome to LOZZA, where our daily rituals quietly become a wellspring of inspiration and tranquility.



TX 471 MMC Single Lever Bath & Shower Set



TX 474 MMC Single Lever Shower Set



# Index Page: Faucet Fittings



**TX 115 MMC**  
Single Lever Lavatory Faucet  
with 1 1/4" Pop-Up Waste



**TX 116 MMC V4**  
Extended Single Lever  
Lavatory Faucet  
with 1 1/4" Pop-Up Waste

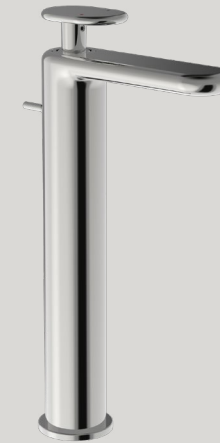

**TX 116 MMC**  
Extended Single Lever  
Lavatory Faucet  
with 1" Pop-Up Waste



**TX 119 MMC**  
8" Lavatory Faucet with  
1 1/4" Pop-Up Waste



# Index Page: Bath Fittings



**TX 467 MMC**  
Bath Filler & Mixer



**TX 447 MMC**  
4 Holes Bath & Shower Set



**TX 494 MMC**  
Floor Standing Bath  
& Shower Set

# Index Page: Shower Fittings



**TX 442 MMC**  
Single Lever Bath &  
Shower Mixer with Diverter



**TX 443 MMC**  
Single Lever  
Shower Mixer



**TX 471 MMC**  
Single Lever Bath  
& Shower Set



**TX 474 MMC**  
Single Lever  
Shower Set



**TX 492 MMC**  
Shower  
Column Set

# Technical Drawings: Faucet Fittings

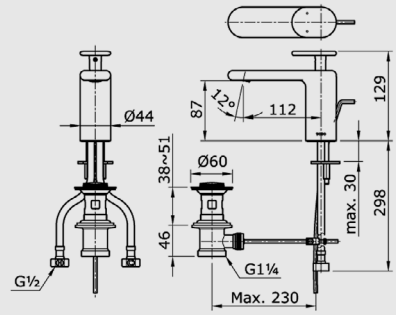

**TX 115 MMC**  
Single Lever Lavatory Faucet  
with 1 1/4" Pop-Up Waste

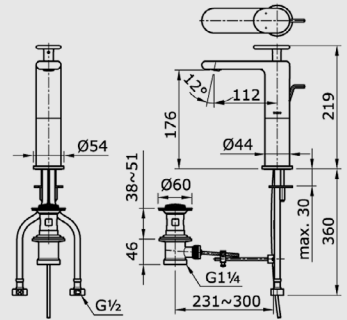

**TX 116 MMC V4**  
Extended Single Lever Lavatory Faucet  
with 1 1/4" Pop-Up Waste

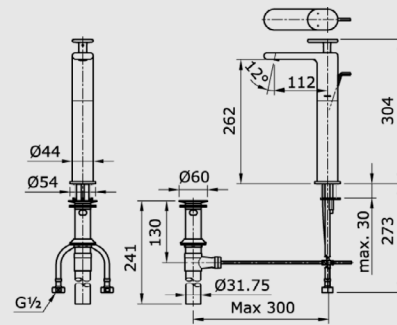

**TX 116 MMC**  
Extended Single Lever Lavatory Faucet  
with 1" Pop-Up Waste

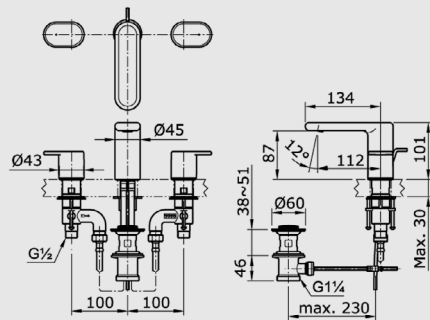

**TX 119 MMC**  
8" Lavatory Faucet with  
1 1/4" Pop-Up Waste

# Technical Drawings: Bath Fittings

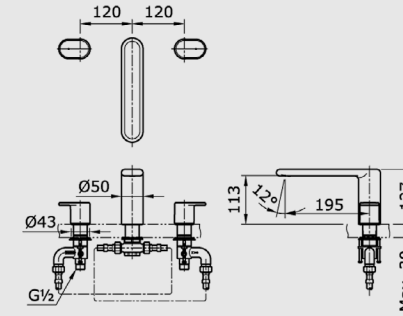

**TX 467 MMC**  
Bath Filler & Mixer

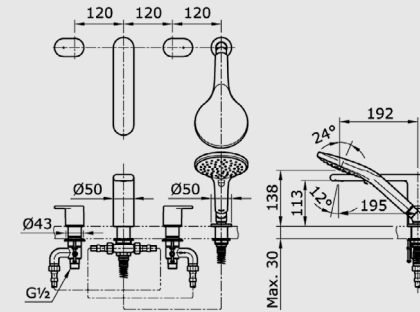

**TX 447 MMC**  
4 Holes Bath  
& Shower Set

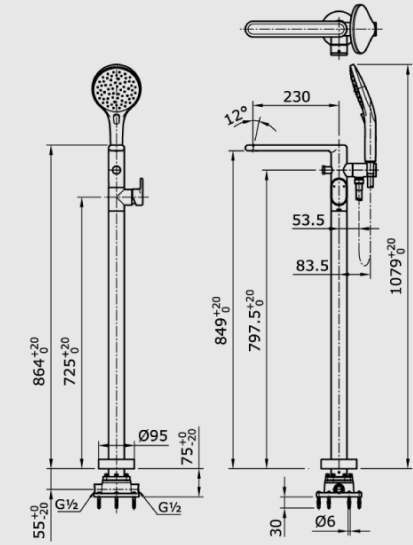

**TX 494 MMC**  
Floor Standing Bath  
& Shower Set

# Technical Drawings: Shower Fittings

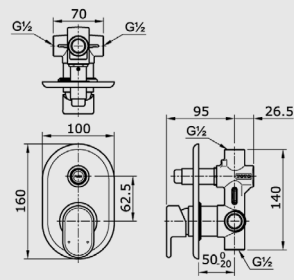

**TX 442 MMC**  
Single Lever Bath &  
Shower Mixer with Diverter

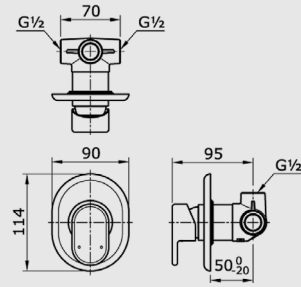

**TX 443 MMC**  
Single Lever  
Shower Mixer

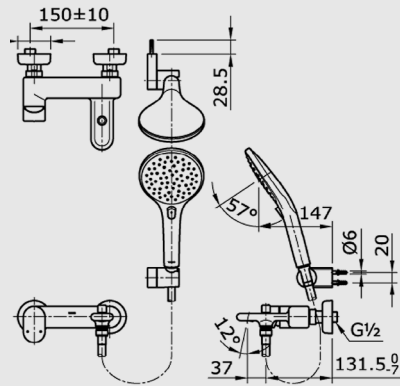

**TX 471 MMC**  
Single Lever Bath  
& Shower Set

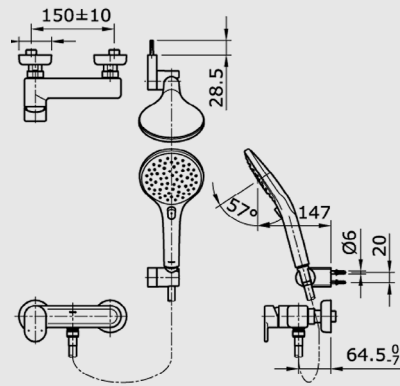

**TX 474 MMC**  
Single Lever  
Shower Set

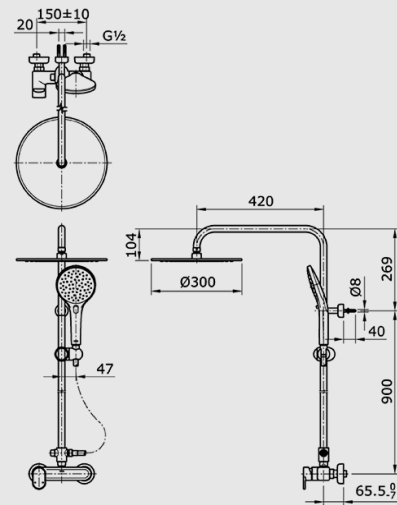

**TX 492 MMC**  
Shower  
Column Set



**TOTO**  
Lozza Series

Designer  
**Alvin Tjitrowirjo**

Manufacturer  
**TOTO**

Graphic Design,  
Photographer,  
Copywriter  
**ZOU**

Rendering  
**Koma Visual & AlvinT**

Printing  
**Binary Print  
& Design Bureau**

Showroom:  
**PT Surya Toto Indonesia Tbk.**  
Jl. Letjen S. Parman Kav. 81  
Jakarta 11420  
Tel. +62 21 2929 8686

Instagram:  
**@toto.indonesia**

Website:  
**www.toto.co.id**



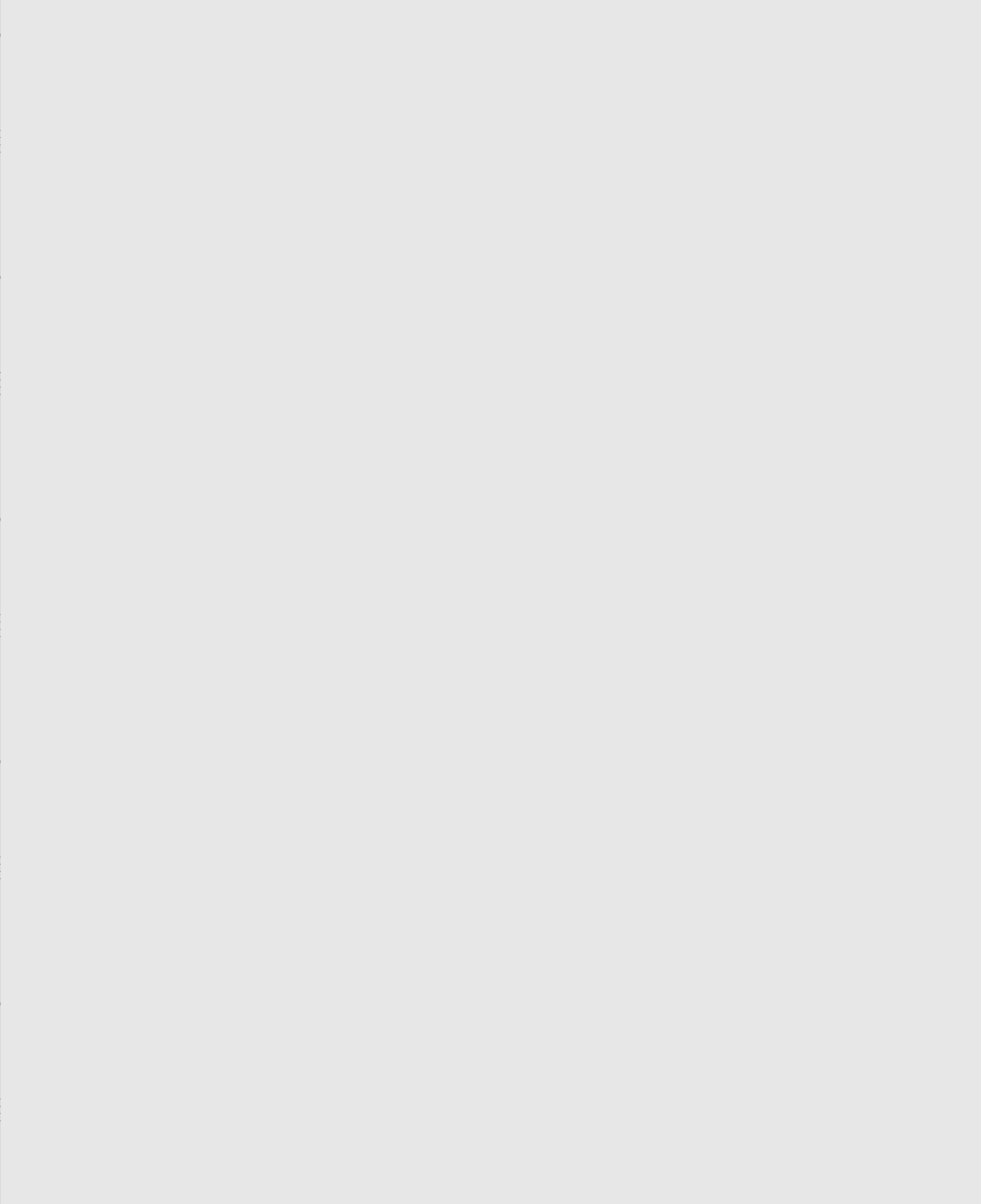
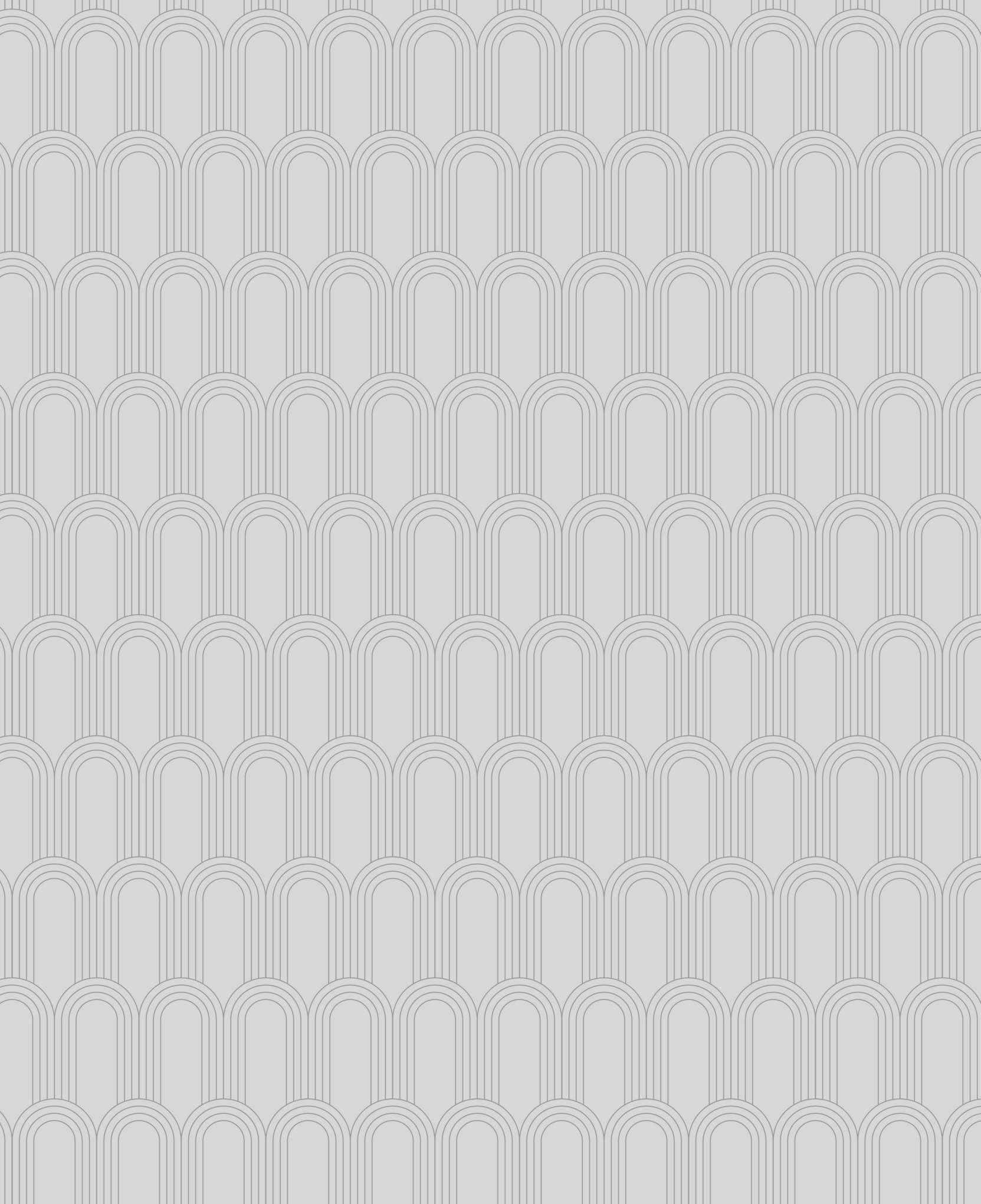

**TOTO**